

A-A (1:2)

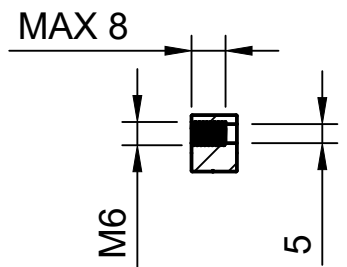

There is two options how to mount controller:

1. Screw controller down with M5 screw
2. Screw M6 screw from bottom to the controller.
Maximum length of thread witch goes to the controller is 8mm.

MATERIAL:			NAME:	DATE:
WEIGHT: 1,2kg			DRAWN: Matous Cmelik	06.09.2018
PROJECTION: [ISO E]			CHECKED:	
ACCURACY:				
TOLERANCE:				
	PART NAME:	SL controller assembly		Size A4
	FILE NAME:	SL_controller_assembly-rev_5		Scale 1:2
		Rev	5	List 1/1